



SLIDING AND FOLDING DOOR SYSTEMS

ALUK[®]

SLIDING AND FOLDING DOOR SYSTEMS

» CONTENTS

Introduction	2-3
BSC94 sliding door system	4-5
BSC70 sliding door system	6-7
BSF70 folding sliding door system	8-9
BSF70 HD folding sliding door system	10-11

Bringing together internal and external environments is a trend that has seen the development of a range of products that enable the opening up of large expanses of a building. AluK has led the way in designing a complete range of folding and sliding door options that allow specifiers to design buildings that engage with their environments.

However, it is essential that these products perform to the standards expected and deliver comfortable living and working environments. The flexibility that these innovative systems offer in combining indoor and outdoor life enables building occupants to live their lives the way they choose.

Our systems combine the strength and lightweight properties of aluminium with form and function of the highest standard. Reliability weather tightness and security are key drivers in the design

of any sliding or folding door system. AluK systems have been rigorously tried and tested to exceed many standards and most are certified under the 'Secured by Design' scheme for security and exceed severe exposure categories for weather tightness.

Combining narrow profiles with high thermal performance, our systems offer wide expanses of glazing that allow natural light to flood into rooms, whilst maintaining internal temperatures and weather tightness when closed. Through a wide range of standard and optional features we can to meet the needs of specifiers and designers in achieving the right look and performance for their project.





➤ BSC94 SLIDING DOOR SYSTEM

The BSC94 aluminium sliding door is a multi-configuration in-line, lift and slide system that allows you to specify and design the most suitable solution for your project. The system is available with fixed and sliding panels as well as single, double and triple track options. Outstanding thermal performance and the highest quality fittings ensure reliable and comfortable operation.

Design Features

- Three chamber in-line slide or lift and slide system
- Up to six panel sliding configurations
- Thermally enhanced extrusions incorporating glass fibre reinforced polyamide strips
- Robust and durable design allowing up to 400kg panel weight for both in-line sliding and lift and slide configurations

Configurations

- (A) One Panel Sliding
- (B) Two Panel Sliding
- (C) Three Panel Sliding
- (D) Four Panel Sliding
- Fixed panels
- Single, Double or Triple Track

Options

- Accepts 20mm - 31mm Double Glazed Units
- In-line or Lift and Slide
- Single, Double or Triple Track options
- Available in single or dual colour, polyester powder coating and anodised finishes

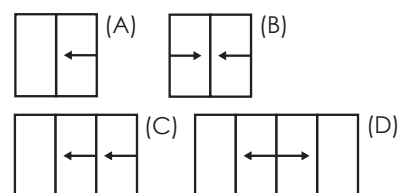

BSC94 sliding door system technical specifications

This flexible sliding door system offers specifiers a range of configurations and options to deliver the most suitable solution for your project. In-line and lift and slide options, multiple track configurations, an extensive range of hardware and a range of door styles, colours and finishes provide the flexibility and performance that designers are looking for when specifying entrance solutions. Anodised finishes are also available with marine grade guarantees on request.

	IN-LINE SLIDING	LIFT AND SLIDE
PERFORMANCE AND ACCREDITATION		
U-Value (Double Glazing)*	1.7 W/m²K	1.8 W/m²K
U-Value (Triple Glazing)*	1.5 W/m²K	1.5 W/m²K
Green Guide Rating	C Rated	C Rated
Acoustic Performance (dB)	Rw (C;Ctr) 36 (-1;-3) dB	Rw (C;Ctr) 36 (-2;-6) dB
Air Tightness (Pa)	Class 4 (600 Pa)	Class 4 (600 Pa)
Water Tightness (Pa)	Class 4 (900 Pa)	Class 7a (300 Pa)
Wind Load (Pa)	C3 (1200 Pa)	C3 (1200 Pa)
Security	EN1627 RC2 and PAS24 (OX and XO configurations)	EN27 RC2
CONFIGURATIONS		
Opening	Sliding	Lift and Slide
1 Pane (OX / XO)	●	●
2 Pane (XX)	●	●
3 Pane (OXO / XXO)	●	-
4 Pane (OXXO)	●	●
SIZE LIMITS		
Max Panel Weight (dependent on qty of rollers)	200 Kg - 400 Kg	300 Kg - 400 Kg
SYSTEM FEATURES		
Frame Options	94mm 106mm 155mm	94mm 106mm
Dual Colour Option	●	●
Multi-Point Locking	●	●
Glazing Options	Internal bead	Internal bead
Glazing Thickness	20mm - 31mm	20mm - 31mm

CAD cross sections and thermal profile

Mono Rail

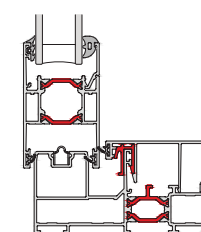

Duo Rail

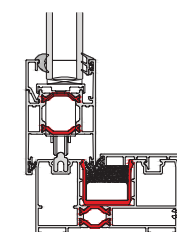

Tri Rail

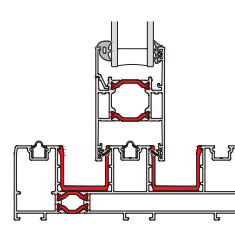

Interlock

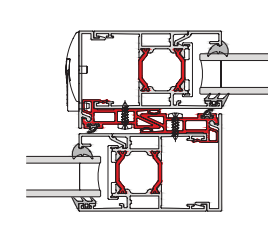

* U-Values based on CEN size door (2000mm x 2180mm) using 1.2 W/m²K double glazing with warm edge Swisspacer V bar. All weather test data taken from BS EN 6375-1 (Part of Pas 23) based upon highest performing door configuration. Sound insulation values are Rw reduction values and are based on tests using acoustic glazing.

Please visit www.aluk.co.uk to download all BIM components and CAD files.



» BSC70 SLIDING DOOR SYSTEM

Versatile and robust, the BSC70 aluminium in-line sliding door system combines narrow sight lines, thermal performance and reliable, secure hardware. Available in a wide range of colours and finishes, this stylish system has been rigorously tested for weather tightness and is suitable for a range of applications including retail, residential, hospitality and commercial.

Design Features

- Reinforced interlock options
- 70mm frame depth
- Narrow profile offering minimal sight lines (42mm interlock)
- Wrap around glazing
- Stainless steel wheels ensures smooth and consistent operation
- Multi-point locking hardware
- Two pane sliding door or window
- In-line track system
- Full range of suited hardware available
- Maximum glazing 28mm

Options

- Available in single or dual colour option, polyester powder coating and anodised finishes

Configurations

- (A) Two pane sliding door
- (B) Two pane sliding window

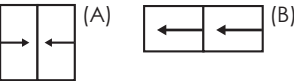

BSC70 sliding door system technical specifications

This flexible sliding door system offers specifiers a competitively priced solution with slim profile sightlines. Available with two pane sliding door or window options and in-line operation, the system can be specified in a wide range of colours and with a comprehensive selection of hardware. Anodised finishes are also available with marine grade guarantees on request.

	IN-LINE SLIDING
PERFORMANCE AND ACCREDITATION	
U-Value (Double Glazing)*	1.7 W/m²K
Green Guide Rating	A Rated
Air Tightness (Pa)	Class 2 (300 Pa)
Water Tightness (Pa)	Class 6A (250 Pa)
Wind Load (Pa)	Class A3 (1200 Pa)
CONFIGURATIONS	
Opening	Sliding
2 Pane (XX)	●
DESIGN FEATURES	
Max Panel Weight	160 Kg
SYSTEM FEATURES	
Frame Options	70mm
Dual Colour Option	●
Multi-Point Locking	●
Glazing Options	Wrap Around
Glazing Thickness	28mm

CAD cross sections and thermal profile

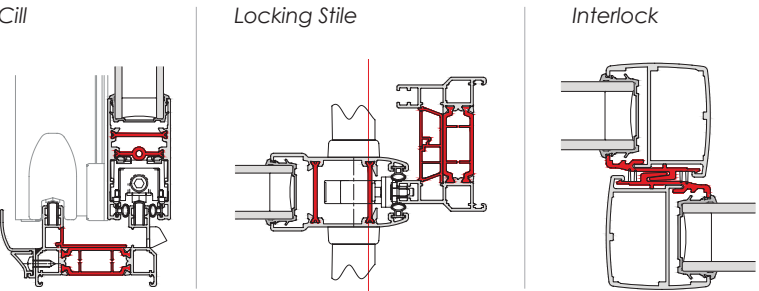

* U-Values based on CEN size door (2000mm x 2180mm) using 1.2 W/m²K double glazing with warm edge Swisspacer V bar. All weather test data taken from BS EN 6375-1 (Part of Pas 23) based upon highest performing door configuration. Sound insulation values are Rw reduction values and are based on tests using acoustic glazing.

Please visit www.aluk.co.uk to download all BIM components and CAD files.



➤ **BSF70**
FOLDING SLIDING DOOR SYSTEM

Versatile and flexible, the market leading BSF70 aluminium folding sliding door system is available in a wide range of configurations to create the look you desire. Multiple panel doors can be combined with open-in or open-out options, in a variety of styles to create a wide expanse of open area. The narrow profile ensures that maximum glazing is achieved, flooding rooms with light even when closed.

Design Features

- Internally beaded with a soffline or square detail to all external doors and panels
- Four stainless steel wheels per carriage ensures smooth and consistent operation
- Unique, flush T-handle that allows maximum door opening and squared stacking panels
- Tested to PAS 24 and certified under the Secured by Design scheme
- Glazing sizing range of 24mm – 40mm

Options

- Doors and panels can be used in a variety of configurations, style and design
- All configurations are available in both open-in and open-out options
- Available in single or dual colour option, polyester powder coating and anodised finishes
- Chamfered and square bead options
- Low threshold option which can be configured to achieve DDA and Part M compliance

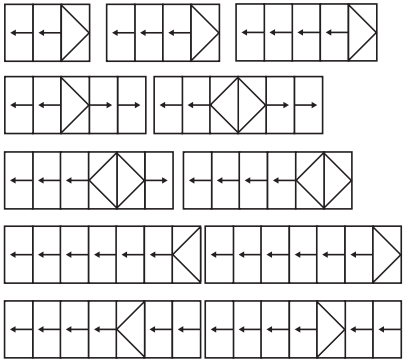

Configurations

The BSF70 folding sliding door system is available in a wide range of configurations as demonstrated. Panels can be stacked inside or outside, to the left or right, or split stacked on both sides.

BSF70 folding sliding door system technical specifications

Combining high security hinges and locking mechanisms with a unique high strength roller designs, the BSF70 aluminium folding sliding door system provides the security and reliability demanded in high traffic applications. Doors can be manufactured to replace whole walls and a full range of colours are available, including single or dual aspect. Anodised finishes are also available with marine grade guarantees on request.

	FOLDING SLIDING	SINGLE and DOUBLE DOOR
PERFORMANCE AND ACCREDITATION		
U-Value (Double Glazing)*	1.7 W/m²K	1.8 W/m²K
U-Value (Triple Glazing)**	1.6 W/m²K	1.4 W/m²K
Green Guide Rating	A Rated	A Rated
Acoustic Performance (dB)	Rw (C;Ctr) 36 (-1;-3) dB	Rw (C;Ctr) 36 (-1;-3) dB
Air Tightness (Pa) (standard threshold)	Class 4 (600 Pa)	Class 4 (600 Pa)
Water Tightness (Pa) (standard threshold)	Class 9a (600 Pa)	Class 9a (600 Pa)
Wind Load (Pa)	Class E2400	Class E2400
Security (standard threshold)	Q-Mark to PAS 24	npd
Secured By Design (rebated threshold)	Yes	No
CONFIGURATIONS		
Opening	Open In and Open Out	Open In and Open Out
2-2-0	●	-
3-3-0	●	-
3-2-1	●	-
4-4-0	●	-
4-2-2	●	-
4-3-1	●	-
5-5-0	●	-
5-3-2	●	-
5-4-1	●	-
6-6-0	●	-
6-3-3	●	-
6-4-2	●	-
6-5-1	●	-
7-7-0	●	-
7-4-3	●	-
7-5-2	●	-
7-6-1	●	-
DESIGN FEATURES		
Max Vent Weight	100 Kg	100 Kg
SYSTEM FEATURES		
Frame Depth	70mm	70mm
Dual Colour Option	●	●
Multi-Point Locking	●	●
Glazing Options	Internal bead	Internal bead
Glazing Thickness	24mm - 40mm	24mm - 40mm

CAD cross sections and thermal profile

Cill

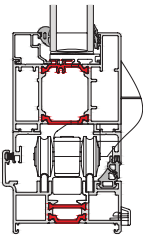

Jam B

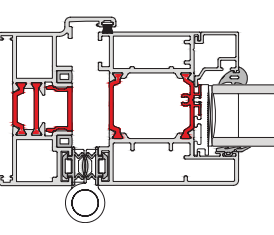

Interlock

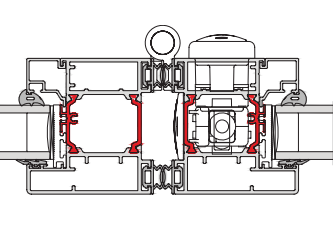

* U-Values based on CEN size door (2000mm x 2180mm) using 1.2 W/m²K double glazing with warm edge Swisspacer V bar. All weather test data taken from BS EN 6375-1 (Part of Pas 23) based upon highest performing door configuration. Sound insulation values are Rw reduction values and are based on tests using acoustic glazing.

Please visit www.aluk.co.uk to download all BIM components and CAD files.



BSF70 HD FOLDING SLIDING DOOR SYSTEM

The BSF70 HD is an innovative folding sliding door system offering incredible acoustic and thermal performance combined with contemporary, sleek profiles. The flexible design allows additional panels with open-in or open-out options, while an alignment pin has been built in to ensure accurate and permanent positioning of the doors for easier installation.

Design Features

- Each panel can hold a glass load of up to 130 Kg
- Internally beaded with a softline or square detail to all external doors and panels
- Four stainless steel wheels per carriage ensures smooth and consistent operation
- Unique, flush T-handle that allows maximum door opening and squared stacking panels
- Tested to PAS 24 and certified under the Secured by Design scheme
- Glazing sizing range of 24mm – 40mm

Options

- Doors and panels can be used in a variety of configurations, style and design
- All configurations are available in both open-in and open-out options
- Available in single or dual colour option, polyester powder coating and anodised finishes
- Chamfered and square bead options
- Low threshold option which can be configured to achieve DDA and Part M compliance

Configurations

The BSF70 HD folding sliding door system is available in a wide range of configurations. Panels can be stacked inside or outside, to the left or right, or split stacked on both sides.

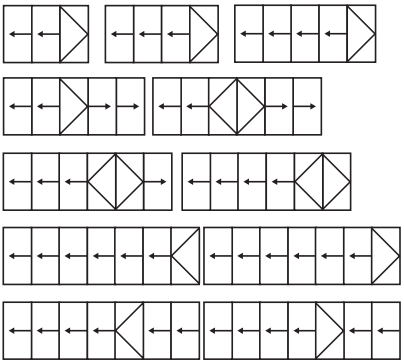

BSF70 HD folding sliding door system technical specifications

Robust and durable, the BSF70 HD provides reliable and consistent operation, holding glass loads of up to 130kg per panel and endurance tested to 25,000 cycles in accordance with BS EN 1527. With accessibility and appearance in mind, the BSF70 HD system is available in a wide variety of configurations, options, and finishes, including anodised or polythene powder coat dual aspect colours, to complement the look and specifications of any building.

	FOLDING SLIDING
PERFORMANCE AND ACCREDITATION	
U-Value (Double Glazing)*	1.7 W/m²K
U-Value (Triple Glazing)**	1.6 W/m²K
Green Guide Rating	A Rated
Acoustic Performance (dB)	Rw (C;Ctr) 36 (-1;-3) dB
Air Tightness (Pa) (standard threshold)	Class 4
Water Tightness (Pa) (standard threshold)	Class 7a
Wind Load (Pa)	Class E2400
CONFIGURATIONS	
Opening	Open In and Open Out
2-2-0	●
3-3-0	●
3-2-1	●
4-4-0	●
4-2-2	●
4-3-1	●
5-5-0	●
5-3-2	●
5-4-1	●
6-6-0	●
6-3-3	●
6-4-2	●
6-5-1	●
7-7-0	●
7-4-3	●
7-5-2	●
7-6-1	●
SIZE LIMITS	
Max Vent Weight	130 Kg
SYSTEM FEATURES	
Frame Depth	70mm
Dual Colour Option	●
Multi-Point Locking	●
Glazing Options	Internal bead
Glazing Thickness	24mm - 40mm

CAD cross sections and thermal profile

Cill HD Roller

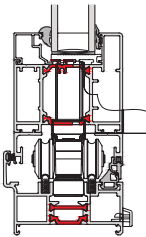

* U-Values based on CEN size door (2000mm x 2180mm) using 1.2 W/m²K double glazing with warm edge Swisspacer V bar. All weather test data taken from BS EN 6375-1 (Part of Pas 23) based upon highest performing door configuration. Sound insulation values are Rw reduction values and are based on tests using acoustic glazing.

Please visit www.aluk.co.uk to download all BIM components and CAD files.



AluK Head Office
Imperial Park
Celtic Way
Newport NP10 8BE
T: 01633 81 04 40
sales@aluk.co.uk

AluK Design Studio
5-11 Worship Street
London
EC2A 2AB
info@alukdesignstudio.co.uk

aluk.co.uk

Registered Office: AluK (GB) Limited, Imperial Park, Celtic Way, Newport, NP10 8BE
Registered Number: 02881320

ALUK[®]